

THE COUNCIL OF THE LONDON BOROUGH OF BARNET

TRAFFIC MANAGEMENT ORDER

2010 No. 97

The Barnet (Bus Lanes) (No. 1) (Amendment No. 2) Traffic Order 2010

Made 9th December 2010

Coming into Operation: 13th December 2010

The Council of the London Borough of Barnet, in exercise of the powers conferred by Section 6 of the Road Traffic Regulation Act 1984(a), as amended, and all other enabling powers hereby make the following Order: -

Commencement and citation

1. This Order may be cited as The Barnet (Bus Lanes) (No.1) (Amendment No. 2) Traffic Order 2010 and shall come into operation on 13th December 2010.

Interpretation

2. Without prejudice to the validity of anything done or to any liability incurred in respect of any act or omission before the coming into operation of this Order, The Barnet (Bus Lanes) (No.1) Traffic Order 2006(b) shall have effect as though for the items numbered 3 and 7 in Schedule 1 to that Order there was substituted the items similarly numbered and set out in the Schedule to this Order.

Dated 9th December 2010

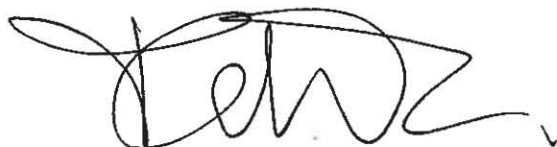

Pam Wharfe
Interim Director of Environment and Operations.

(a) 1984 c.27

(b) LBB 2006 No. 109

LONDON BOROUGH OF BARNET

The Barnet (Bus Lanes) (No. 1) (Amendment No. 2) Traffic Order 2010

STATEMENT OF REASONS

As part of a Congestion Reduction Scheme on the A5, various traffic engineering measures have been identified to improve traffic flow and road safety.

The general effect of the Order will be to remove the section of bus lane on The Hyde NW9 immediately south of Colindale Avenue in order to improve traffic flow and increase capacity through the junction, by allowing two lanes of traffic to travel southbound through the junction.

The changes are shown on the attached drawing 60554_TRO_006

THE LONDON BOROUGH OF BARNET

The Barnet (Bus Lanes) (No. 1) (Amendment No. **) Traffic Order 20**

EXPLANATORY NOTE

(This note is not part of the Order, but is intended to indicate its general purport)

This Order removes existing lengths of bus lanes in the London Borough of Barnet.

LONDON BOROUGH OF BARNET

Schedule Bus Lanes

(1) Item	(2) Lengths of Road	(3) Times of Operation	(4) Direction of travel and type of bus lane	(5) Type of permitted vehicle
3	The Hyde, north-east side, between a point 62.6 metres south-east of the south-eastern kerblines of The Greenway, and a point 51 metres north-west of the north-western kerblines of Colindale Avenue	Monday to Saturday 7am to 10am and 4pm to 7pm	South-east bound with-flow lane	Bus, Taxi, Pedal cycle, Dial-a-ride bus
7	Cricklewood Broadway, north-east side, between a point 23.5 metres south-west of a point opposite the north-eastern boundary wall of No. 400 Edgware Road, and a point 26.0 metres north-west of the south-eastern flank wall of No. 318 Cricklewood Broadway	Monday to Saturday 7am to 10am and 4pm to 7pm	South-east bound with-flow lane	Bus, Taxi, Pedal cycle, Dial-a-ride bus

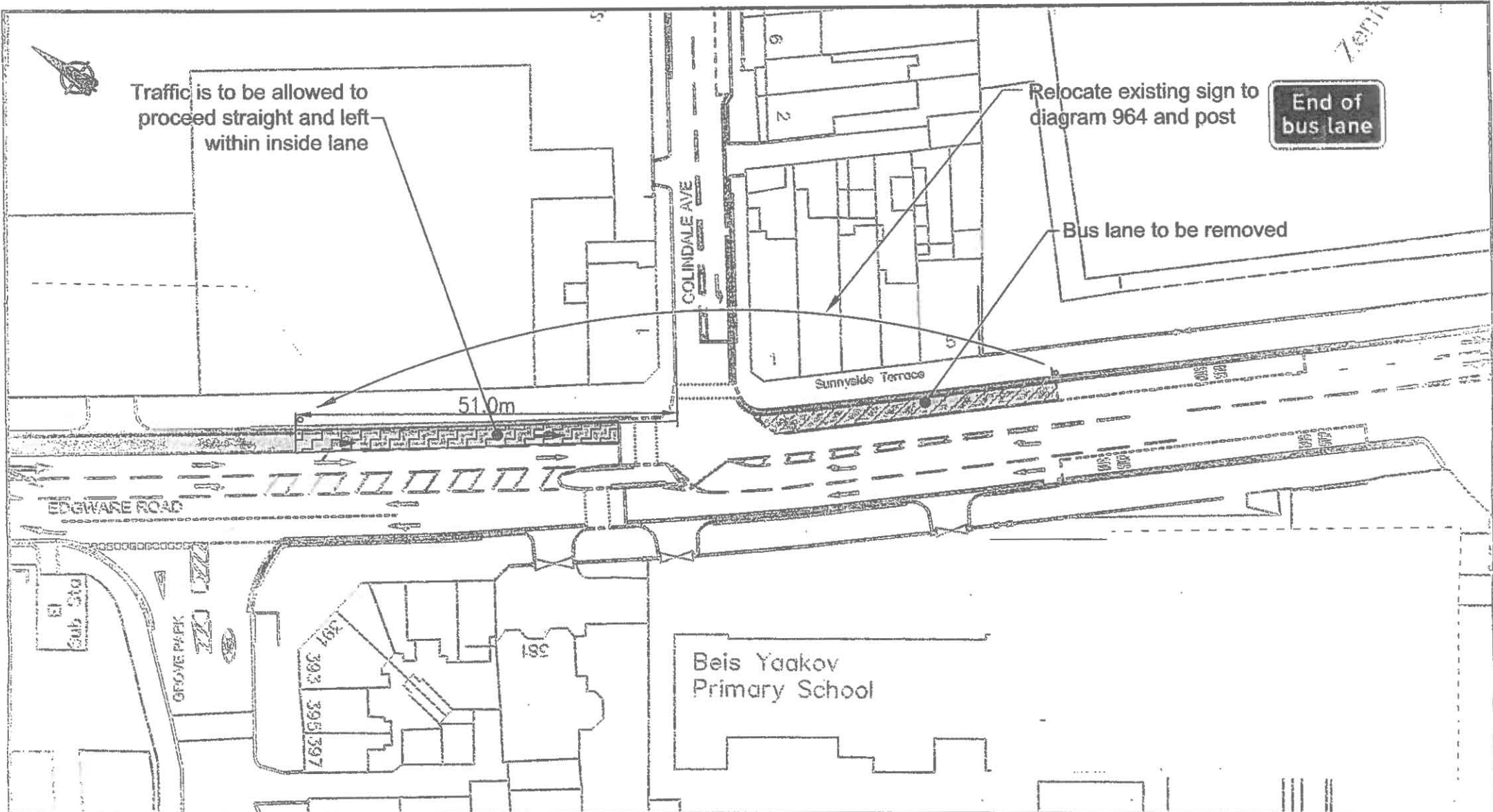

Initiated by AA	SCHEME: A5 CONGESTION REDUCTION AND SAFETY PROPOSALS	Pam Warfe Interim Director of Environment and Operations	<div style="text-align: center;"> BARNET LONDON BOROUGH DESIGN TEAM </div>
Drawn by MK			
Checked by AA	TITLE: BUS LANE REMOVAL - EDGWARE ROAD, SOUTH OF COLINDALE AVENUE TRO DRAWING	North London Business Park Oakleigh Road South New Southgate N11 1NP Tel. 020 8359 2000	DRAWING No. 60554_TRO_006
Date JAN 10			Acad Ref.
Scales NTS			